

# North I-25 Industrial for Lease

4906- 4946 Jefferson Street, Albuquerque, NM

## PROPERTY TYPE:

Industrial

## BUILDING SIZE:

66,000± sq. ft. in two buildings

## AVAILABLE:

4920 – 1,500± sq. ft.  
4932 – 3,033± sq. ft.  
4934 – 5,023± sq. ft.  
4944 – 3,000± sq. ft.

## SALE/LEASE RATE:

\$7.00/sq. ft. + NNN

4926 – 12,000 ± sq. ft.  
Available June 1, 2012

## SUBMARKET:

North I-25

## ZONING:

M-1

## FEATURES:

- Dock & Drive In Doors
- Easy Freeway Access
- 16' Clear Height
- Convenient North I-25 Location



## FOR MORE INFORMATION PLEASE CONTACT:

**Tom Jenkins, SIOR**

Qualifying Broker/ Principal  
505.217.9555  
tom@reanm.com

**Mark Friedman, CCIM**

Principal  
505.217.9530  
mark@reanm.com

The information provided herein has been obtained from sources believed reliable. While we do not doubt the accuracy, we may not have verified it and make no guarantee, warranty or representation about it. It is your responsibility to independently confirm its accuracy and completeness. Any projections, opinions, assumptions or estimates used are for example only and do not represent the current or future performance of the property. The value of this transaction to you depends on tax and other factors which should be evaluated by your tax, financial and legal advisors. You and your advisors should conduct a careful, independent investigation of the property to determine to your satisfaction the suitability of the property for your needs.

# North I-25 Industrial for Lease

4906- 4946 Jefferson Street, Albuquerque, NM

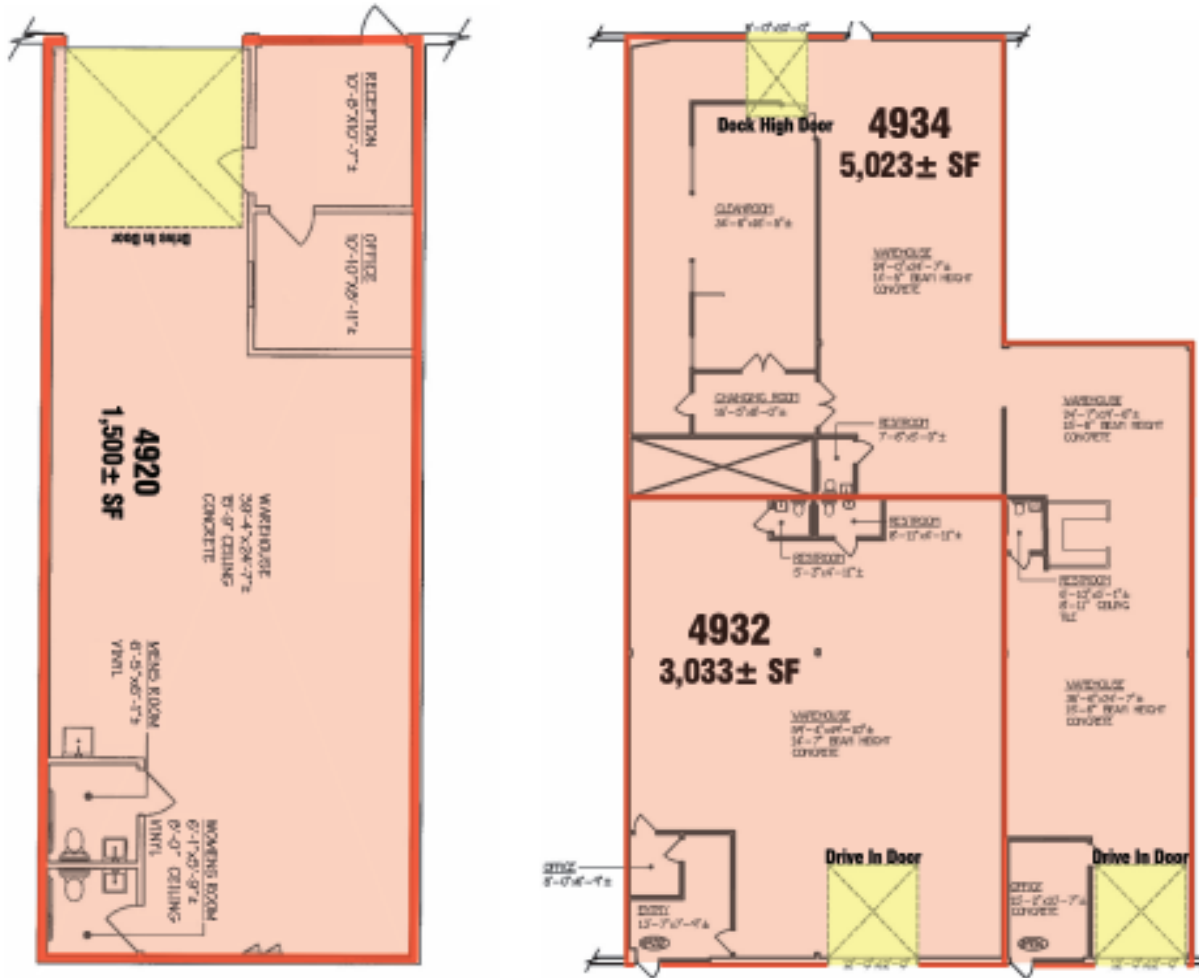

The information provided herein has been obtained from sources believed reliable. While we do not doubt the accuracy, we may not have verified it and make no guarantee, warranty or representation about it. It is your responsibility to independently confirm its accuracy and completeness. Any projections, opinions, assumptions or estimates used are for example only and do not represent the current or future performance of the property. The value of this transaction to you depends on tax and other factors which should be evaluated by your tax, financial and legal advisors. You and your advisors should conduct a careful, independent investigation of the property to determine to your satisfaction the suitability of the property for your needs.